



WELLINGTON AVENUE

NOTES

This drawing to be read in accordance with the specification/Bills of Quantities and related drawings.

No Dimensions to be scaled from this drawing. All stated dimensions to be verified on site and the Architect notified of any discrepancies.

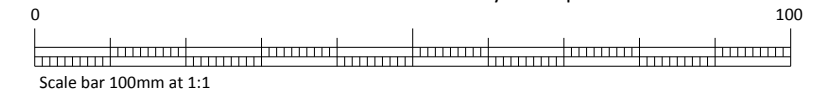

Reproduced from OS Mastermap by permission of Ordnance Survey © on behalf of the Controller of Her Majesty's Stationery Office. © Crown Copyright 2012. All rights reserved. Reference number 1021522

NOTES

- Existing levels have been taken from Ordnance Survey and Topographical Information provided by others.
- Currently proposed levels are as provided by Civil Engineer and subject to change following any detailed site levels investigation.
- Highways arrangement is shown indicatively only; refer to Highway Engineer's drawings for detailed highways proposal. Proposed works are subject to agreement with Local Highways Authority.
- Landscaping is shown indicatively only; refer to Landscape Architect's drawings for detailed landscape proposals.
- Store footprint and internal arrangement subject to retail planning approval.

APPLICATION BOUNDARY

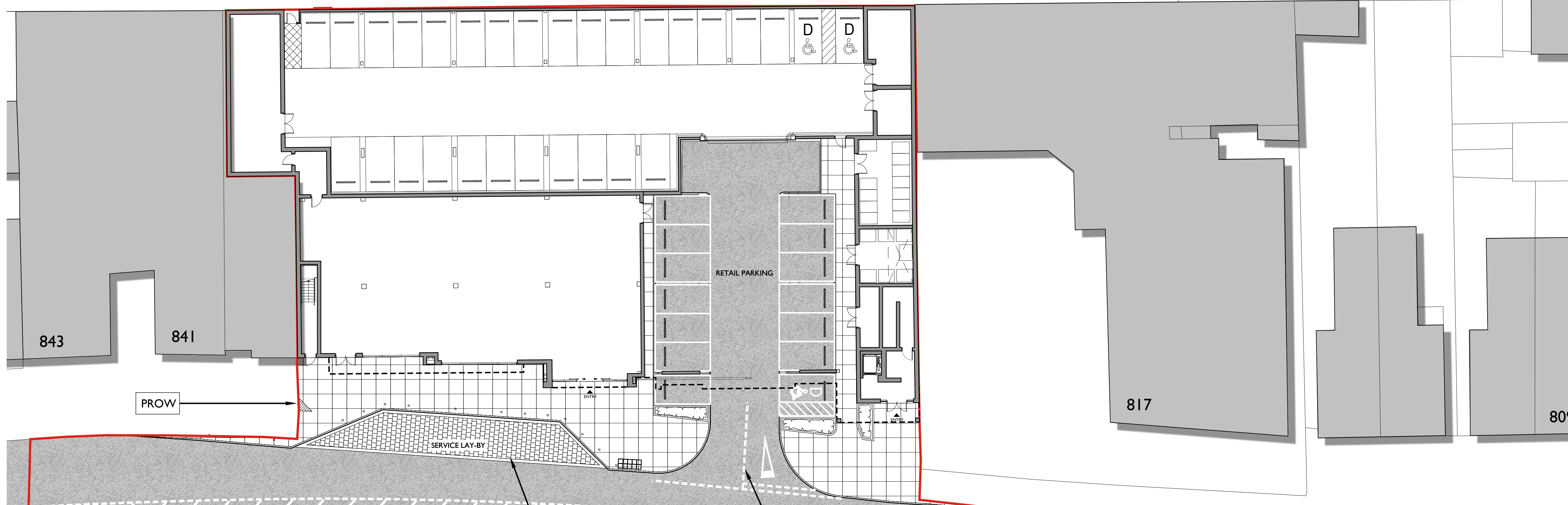
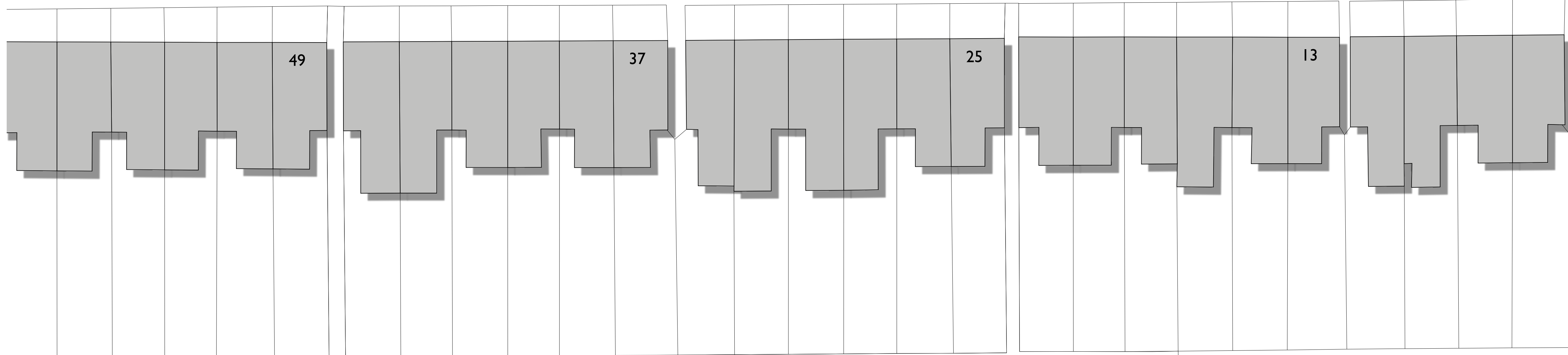

FOR PLANNING

REV.	DATE	NOTE	IN
C	16.03.17	AMENDMENTS FOLLOWING CLIENTS & PLANNING COMMENTS	SM
B	17.02.17	AMENDMENTS FOLLOWING CLIENTS & PLANNING COMMENTS	BV
A	14.02.17	AMENDMENTS FOLLOWING CLIENTS COMMENTS	BV

Project
PROPOSED MIXED USE DEVELOPMENT
LONDON ROAD
WESTCLIFF-ON-SEA

Title
PROPOSED SITE PLAN
GROUND FLOOR

Scale
 1:200 @ A1
 Date
 JAN 2017

Drawn
 BV
 Checked
 RC

Drawing Number
6766/301.4
 Revision
C

Saunders
 Architecture + Urban Design

